



PLASTERING ACCESSORIES



Plastering Accessories

Introduction

Advanced Construction Supplies Factory (Lawazem) based in Riyadh, Kingdom of Saudi Arabia, producing specialized building materials.

As a key success factor, LAWAZEM owners and management team realize the importance of attracting and retaining a well-skilled and trained human capital.

Accordingly, LAWAZEM has strived through the past years to employ, train and build a reliable and dedicated operational and technical team.

By applying the latest manufacturing methodologies and the latest technologies, LAWAZEM has been able to provide its customers with high quality products that meet the international and regional industrial standards and specifications.

Through the dedication, passion and quality focus, LAWAZEM has been able to meet and exceed its customer's expectations in terms of the provided range of products, delivered quality, availed support and fulfilling the promises.

Angle Bead

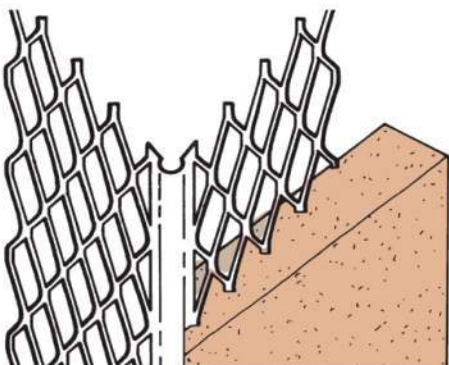

Code	Description	Wing width(mm)	Length (mm)	Packing pcs
P1	Angle beads	50 x 50	3000	50
P2	Angle beads	70 x 70	3000	50

LAWAZEM Angle Bead provides a true straight arris that will not easily chip or crack. It also serves as a straight edge and guide for planning of plaster and speeds up the operation of setting out the aaris.

LAWAZEM Angle Beads have a zinc coating of 305g/m² which matches with the requirement of BS 6452 and ASTM 653

Plastering Accessories

Plaster Stop Bead

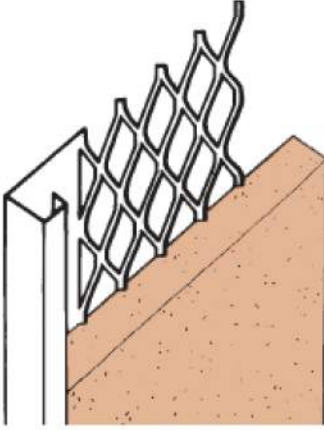

Code	Description	Wing width(mm)	Length (mm)	Packing pcs
P3	Plaster Stop	10	3000	50
P4	Plaster Stop	13	3000	50
P5	Plaster Stop	16	3000	50
P6	Plaster Stop	19	3000	50

LAWAZEM Plaster Stop Bead is excellent to use wherever a finished edge is required. Lawazem Plaster Beads have a zinc coating of 305g/m² which matches with the requirement of BS 6452 and ASTM 653

Control Joint Bead

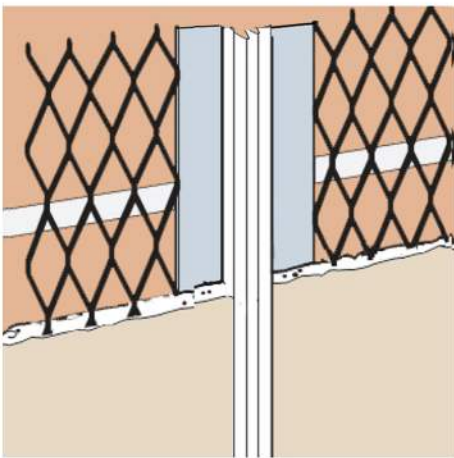

Code	Description	Wing width(mm)	Length (mm)	Packing pcs
P7	Control joint bead	10	3000	25
P8	Control joint bead	13	3000	25
P9	Control joint bead	16	3000	25
P10	Control joint bead	19	3000	25

LAWAZEM Control Joint Beads assist in relieving stress in large plaster areas by reducing to series of smaller segments.

LAWAZEM Control Joint Beads have a zinc coating of 305g/m² which matches with the requirement of BS 6452 and ASTM 653

Plastering Accessories

Angle Mesh (Corner Mesh)

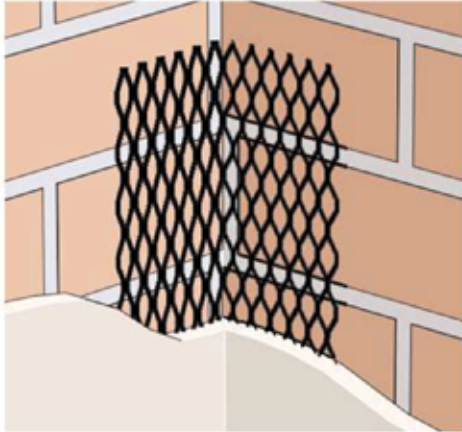

Code	Description	Wing width(mm)	Length (mm)	Packing pcs
P11	Angle Mesh	50 x 50	3000	50
P12	Angle Mesh	70 x 70	3000	50

LAWAZEM Angle Mesh (Corner Mesh) is used for reinforcing internal and external corners and at window/door reveals.

LAWAZEM Angle Mesh (Corner Mesh) has a zinc coating of 305g/m² which matches with the requirement of BS 6452 and ASTM 653

Architrave Bead

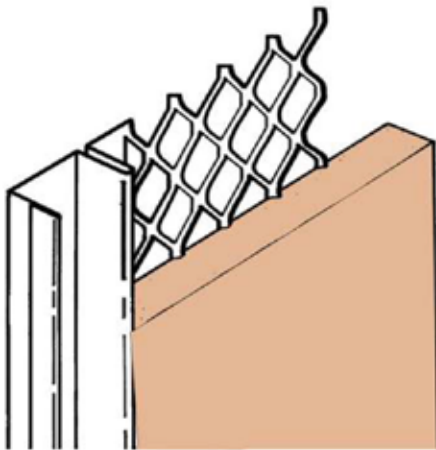

Code	Description	Coil Wing Splice(mm)	Length (mm)	Packing pcs
P13	Architrave beads	13	3000	25
P14	Architrave beads	16	3000	25
P15	Architrave beads	19	3000	25
P16	Architrave beads	23	3000	25

LAWAZEM Architrave Bead is used to create clean divisions between varying wall finish such as doors and windows reveals.

LAWAZEM Architrave Beads have a zinc coating of 305g/m² which matches with the requirement of BS 6452 and ASTM 653

Plastering Accessories

Depth Gauge

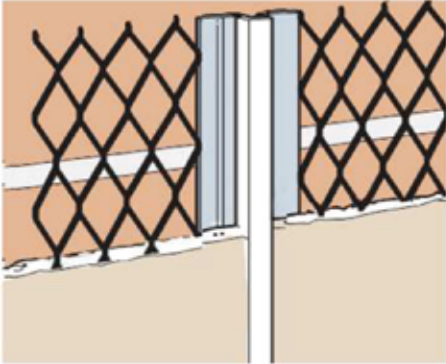

Code	Description	Coil Width Spice(mm)	Length (mm)	Packing pcs
P29	Depth Gauge	10	50	25

LAWAZEM Depth Gauge is used to provide a quick and accurate means of ensuring consistent, minimum plaster depths as plaster is simply ruled off to leave the required thickness. Depth Gauge Beads may also be used to separate plaster areas and as a striking bead.

LAWAZEM Depth has a zinc coating of 305g/m² which matches with the requirement of BS 6452 and ASTM 653.

Strip/Coil Mesh



Code	Description	Coil Wing Spice(mm)	Length (mm)	Packing pcs
P17	Strip / Coil Mesh	100	15	25
P18	Strip / Coil Mesh	150	15	25
P19	Strip / Coil Mesh	200	15	25
P20	Strip / Coil Mesh	100	30	25
P21	Strip / Coil Mesh	150	30	25
P22	Strip / Coil Mesh	200	30	25

LAWAZEM Strip Mesh (brake reinforcement) is used to provide a bond between dissimilar materials and at crack-prone areas adjacent to openings.

LAWAZEM Strip Mesh has a zinc coating of 305g/m² which matches with the requirement of BS 6452 and ASTM 653.

Plastering Accessories

Rib-lath

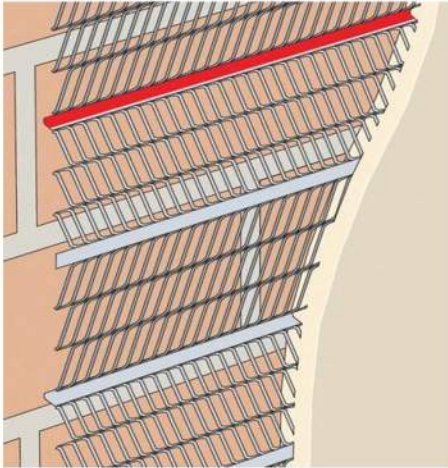

Code	Rib height	Thickness	Sheet size
P23	8 mm	0.4 mm	2500 X 600 mm

LAWAZEM Rib-Lath; widely used as a plaster backing on ceilings, walls and stud partitions. It is suitable for internal and external applications, easily formed which allows designers to create free forms such as arches, domes and vaults in a trouble-free manner. The tensile strength offering excellent plaster base and reinforcement for all types of walls, ceilings and fireproofing of steel beam and columns.

Metal Lath

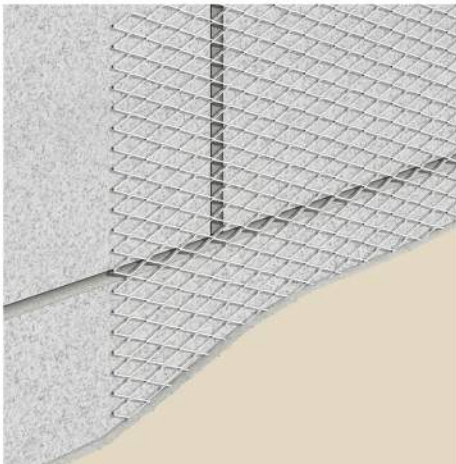

Code	Description	Sheet Size (mm)	Thickness (mm)	Weight (kg)
P24	Metal Lath	600 x 2440	0.3	0.9
P25	Metal Lath	600 x 2440	0.4	1.15
P26	Metal Lath	600 x 2440	0.5	1.5
P27	Metal Lath	600 x 2440	0.6	1.8

LAWAZEM Metal Lath provides a versatile base for plastering. It's carefully formed diamond keys allows for proper embedment and keying of the scratch coat on all types of plastering.

LAWAZEM Metal Lath can be used with hand and machine applied plastering.

LAWAZEM Metal Lath has a Zinc coating of 305g/m² which matches with the requirement of BS6452 and ASTM 653.

Plastering Accessories

Hy Rib

Code	Description	Sheet Size (mm)	Space between the rib (mm)	Weight (kg)
P28	Hy Rib	445 x 3000	89	2.25

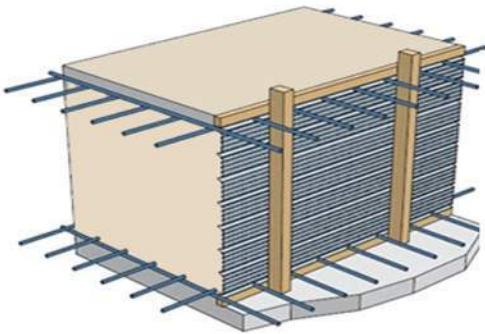

LAWAZEM Hy Rib provides a versatile base for plastering. It is primarily used in construction joint applications but also used to form wall, beam & column surfaces and slabs soffits, where the formed surface will not be seen.

LAWAZEM Hy-Rib outperforms the normal joints in shear and bond and it reduces the risk of trapped air and voids within the concrete. This improves site productivity and minimizes wastage.

LAWAZEM Hy-Rib Lath has a Zinc coating of 305g/m² which matches with the requirement of BS6452 and ASTM 653.

CONTACT

Riyadh | Kingdom of Saudi Arabia

Tel : +966597832857

E-mail : sales@lawazem.co

gm@lawazem.co

 Lawazem Construction Supplies Co

 Lawazem_Co

 Lawazem Co

